

SAVE \$3.40

Our annual subscription is only \$7.00 — mailed directly to your home every Thursday — as compared to \$10.40 if purchased by you each week. Just call our Circulation Dept. today at 322-5266.

SCOTCH PLAINS  
FANWOOD  
SCOTCH PLAINS, N.J.  
07075

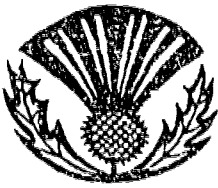

SCOTCH PLAINS

# THE TIMES



FANWOOD

VOLUME 19 NUMBER 28

SCOTCH PLAINS • FANWOOD, N.J.

THURSDAY, JULY 14, 1977

20 CENTS

## Plans For Downtown Park Jell In S.P.

An arbor ... a sunken sculpture garden ... a water wall ... a tree-bordered amphitheater. Sound like Sterling Forest, or Duke Gardens? Wrong! The description is that of a mini-park now in the planning stages for the center of Scotch Plains, adjacent to the Municipal Building. The park nears reality, as Township officials approach final decisions on design and facilities.

Last week, members of the Scotch Plains Council zeroed in on one of three design alternatives prepared by M. Paul Friedberg And Partners, a New York landscape architect engaged to design the facility. The park, which will occupy the vacant land next to the Municipal Building as well as two township-owned lots on either side of Cannonball House on Front Street, will be a passive, restful park. It will be primarily for use by senior citizens, rather than a recreational facility for youth. Low maintenance, quiet, and natural surroundings will set the pace.

Mayor Ann B. Wodjenski expressed pleasure at the park plans. She also expressed her hope that the park will add an attractive plus to the Scotch Plains business district. "We feel the mini-park will certainly be an attractive addition to downtown, and will eventually provide a touch that will help draw successful businesses to the environs," the Mayor stated.

A series of low steps will take the pedestrian off Park Avenue, down into an amphitheatre. Within the amphitheatre section, there will be a podium, suitable for concerts and program. Designed in a semi-circle, the podium will be bordered by a "water wall." Township Manager James Hauser explained this week that an area of water

was considered important in the design of the park, because of the positive sound-deadening effects. It has been found in Manhattan's many vest-pocket parks that water walls help to keep out the sounds of traffic, as do trees. The Council members wanted both water and many, many trees used, particularly along the border of Park Avenue, because 18,000 cars a day pass through the business section.

Council has already received approval for the funding of demolition of two buildings — one a home east of the Cannonball Historical Museum, bordering the municipal drive, the other the house west of Cannonball, which had heretofore housed "Resolve," a youth counseling agency. Instead of the Resolve building, there would be an arbor of flowering cherry trees in the park of tomorrow. The home to the east of Cannonball has a stone foundation which would be particularly suitable to use as the walls of a sculpture garden.

Low-level lighting and large trees will ensure visibility. Seating areas will be spotted throughout the park. Orchards and tree groupings will be located in all areas. Specialized gardens, including a Colonial herb garden, appropriately located near the historical museum, as well as formal English maze-type gardens, will pro-

Continued On Page 2

## Tennis Lights To Go On Soon

"Tennis under the lights" will soon be commonplace for the fortunate players of Scotch Plains. The official throwing of the switch on court lights is scheduled for next week. Existing courts as well as two new ones under construction will be lighted for evening play.

Scotch Plains received a \$60,000 Green Acres grant for park improvements at Kramer Manor park. The township put up matching funds. The money will buy, among other things, two new courts, one all-purpose skating rink-basketball court, and lights for the new and the three old tennis courts.

Township Manager James Hauser said he expects all the improvements to be completed by the end of August. The lights on the old tennis courts should be in operation well before that, Marks said.

## FBI Investigating Local Bank Robbery

A spokesman for the FBI has contacted the Scotch Plains Times with information on a bank robbery which took place here on July 7. On that date, at 1:25 pm, a lone black male, in his late 20's, entered the Lincoln Federal Savings Bank at 361 Park Avenue, and announced to a bank teller that he was holding up the bank and demanded money.

The teller gave him an undisclosed amount. He carried no visible weapons. He ran from the bank with the money. At present, there is no information

Continued On Page 3

## Mason Is First Witness As State Cheering Investigation Opens Here

James Mason, a black teacher at Scotch Plains-Fanwood High whose complaints opened the door to a retrial for varsity cheerleaders at Scotch Plains-Fanwood High School this spring, was the first witness called to testify in an investigation which began this week. He claims cheerleading tryouts were unfair to white as well as black students. L.E. "Buck" Law of the N.J. Department of Education's Division of Controversies and Disputes, opened a three-day session at the Union County Superintendent's Office in Westfield in response to a petition filed by parents of girls who tried out for the cheerleading squad the first time, made it, and then were required to try again.

Back in March, Mason had come forth after the tryouts to complain that the tryouts were unfair and discriminatory. He and parents of some of the black candidates for the cheering squad registered strong protests to the school principal, Superintendent of Schools and the

Board of Education after which the Board ordered retrials.

Mason, under questioning by Walter Lieb, an attorney representing the parents of the girls who originally made the squad, identified areas of the original trials he objected to. One judge

Continued On Page 7

## Committee Paves Way For Cable TV Here

Cable television is encouraged in Scotch Plains. In fact, all the necessary legal steps are underway to pave the way for the service within the community. A Cable T.V. Committee, named by Mayor Anne Wodjenski in March and headed by Ellen Spingler, has been studying the requirements for cable television here, and this week filed an interim report to Mayor and Council informing them on actions taken.

The Cable T.V. Committee has obtained a resolution from Council encouraging the service for Scotch Plains. Committee members have also familiarized themselves with the way cable t.v. works in neighboring communities, through personal interviews and studies of franchises in other communities.

Paul Deisendorf, a representative of the state office of Cable Television, has been of assistance to the local committee, and has outlined the legal procedures to be followed after an application has been filed for a franchise here. That has not yet been done.

The Public Utilities Commission of New Jersey regulates cable television, and there must be very close adherence to the restrictions laid down by this agency. In Scotch Plains, an effort is underway to encourage a company or companies to file an application for a franchise, working within the limits of the law. Toward that end, the Cable T.V. Committee has written to trade organizations expressing interest. Members have also visited two companies — Suburban Cablevision in East Orange, and Plainfield Cablevision in Plainfield. These are now the only two companies operating

Continued On Page 7

## Calendar

**Thursday, July 14** — Special meeting, Bd. of Education (regular agenda session cancelled); meeting is for discussion of cafeteria accounts, report from Superintendent on business office operation, and discussion of procedures for search for new superintendent.

**Tuesday, July 19** — Regular meeting of the Scotch Plains Township Council, Municipal Building, Scotch Plains, 8:15.

## Index

CHIT CHAT	8
CLASSIFIED ADS	25
EDITORIALS	4
ENGAGEMENTS	8
LAW ENFORCEMENT	15
LEGALS	26
REAL ESTATE	23
RELIGIOUS SERVICES	16
SENIOR CITIZENS	15
SERVICES	26
SPORTS	18
YMCA	21

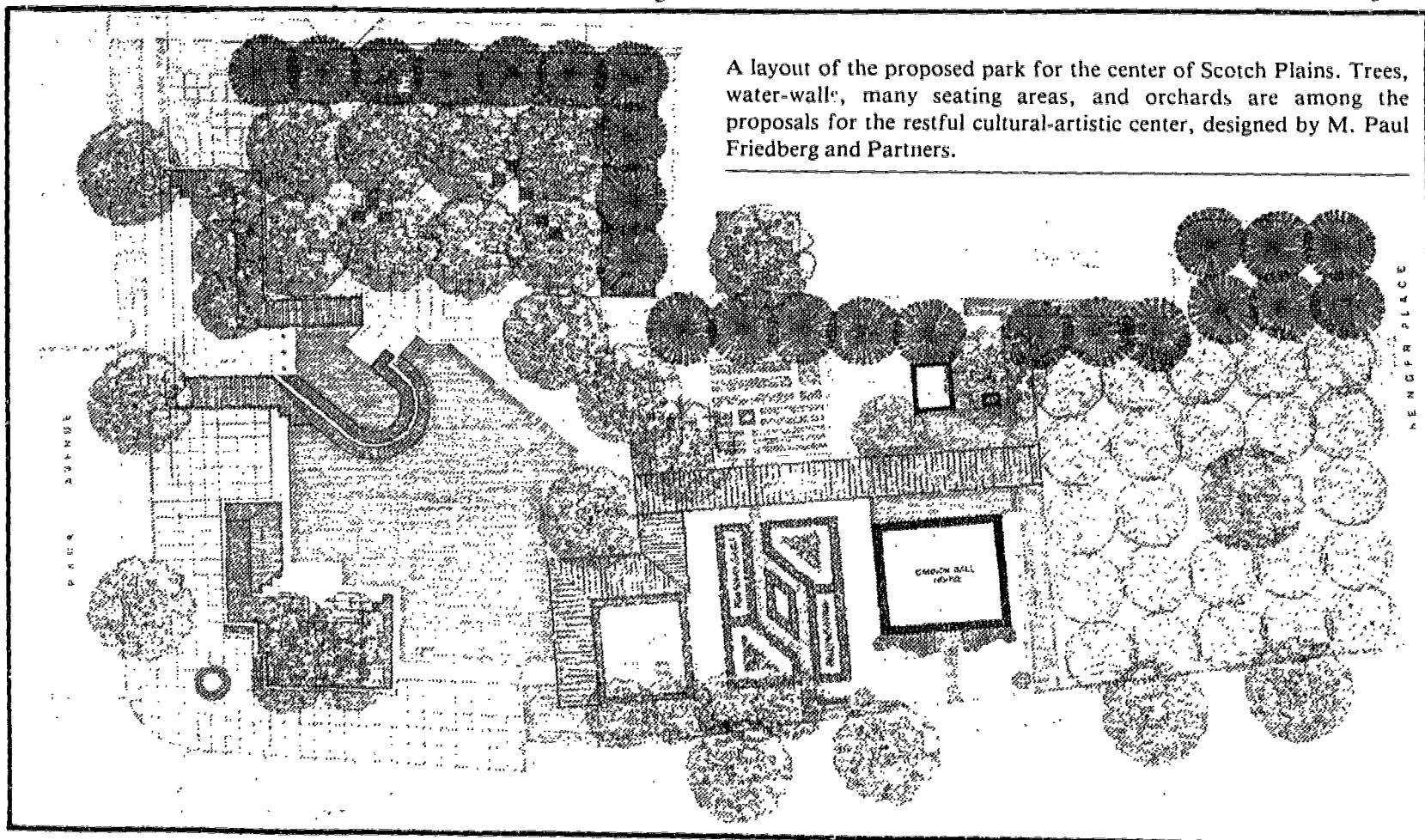

A layout of the proposed park for the center of Scotch Plains. Trees, water-wall, many seating areas, and orchards are among the proposals for the restful cultural-artistic center, designed by M. Paul Friedberg and Partners.